

PLACE ARROW INDICATING NORTH
DIRECTION RELATIVE TO CROSSING

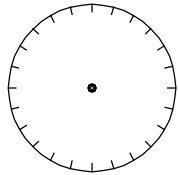

OVERHEAD WIRELINE CROSSING

750 VOLTS OR LESS

NOTE: ALL AVAILABLE DIMENSIONS MUST BE FILLED IN TO PROCESS THIS APPLICATION.

NO SCALE

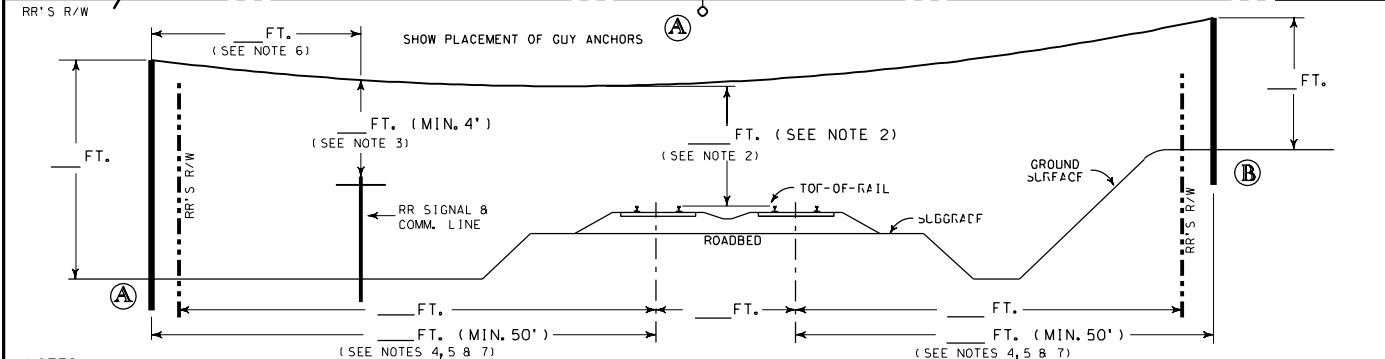
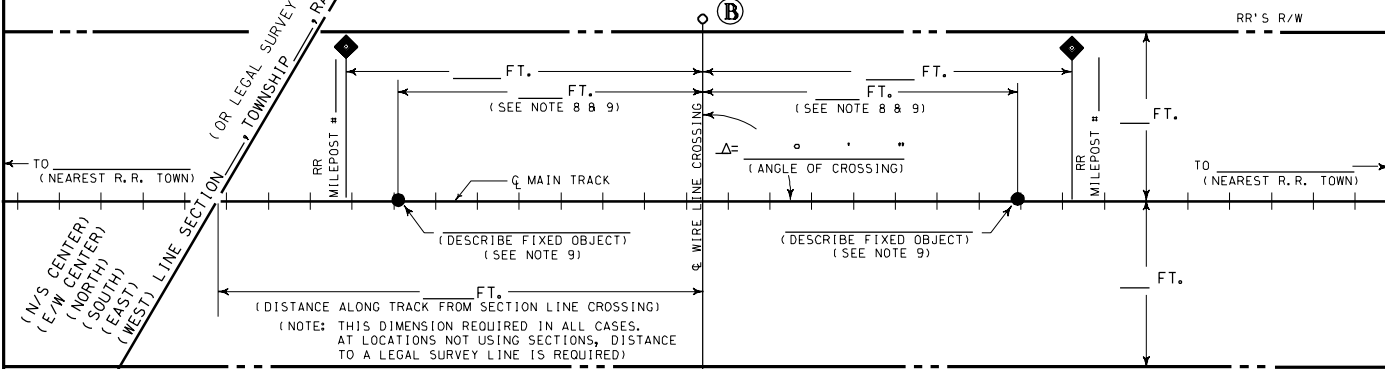

- NOTES :
- 1) ALL HORIZONTAL DISTANCES TO BE MEASURED AT RIGHT ANGLES FROM \mathcal{C} OF TRACK, EXCEPT AS NOTED.
 - 2) MINIMUM 23.5' OR 24' ABOVE TOP-OF-RAIL CLEARANCE REQUIRED, REFER TO WIRELINE CLEARANCE CHART.
 - 3) MINIMUM 4' CLEARANCE REQUIRED ABOVE SIGNAL AND COMMUNICATION LINES, REFER TO WIRELINE CLEARANCE CHART.
 - 4) POLES MUST BE LOCATED 50' OUT FROM \mathcal{C} OF OUR MAIN, BRANCH, AND RUNNING TRACKS, CTC SIDINGS, AND HEAVY TONNAGE SPURS.
 - 5) REGARDLESS OF THE VOLTAGE, UNGUYED POLES SHALL BE LOCATED A MINIMUM DISTANCE FROM \mathcal{C} OF ANY TRACK EQUAL TO THE HEIGHT OF POLE ABOVE GROUNDLINE PLUS 10 FEET.
 - 6) POLE(S) (INCLUDING STEEL POLES) MUST BE LOCATED A MINIMUM DISTANCE FROM OUR SIGNAL AND COMMUNICATION LINES EQUAL TO THE HEIGHT OF THE POLE ABOVE GROUNDLINE OR ELSE BE GUYED AT RIGHT ANGLES TO OUR LINES.
 - 7) POLE LOCATION ADJACENT TO INDUSTRY TRACKS MUST PROVIDE AT LEAST 10' CLEARANCE FROM \mathcal{C} OF TRACK WHEN MEASURED AT RIGHT ANGLES. IF LOCATED ADJACENT TO CURVE TRACK, THEN SAID CLEARANCE MUST BE INCREASED AT A RATE OF 1-1/2" PER DEGREE OF CURVE TRACK.
 - 8) POWER LINES MUST BE LOCATED A MINIMUM OF 500' FROM THE END OF ANY RAILROAD BRIDGE OR 300' FROM \mathcal{C} OF ANY CULVERT.
 - 9) ALLOWABLE FIXED OBJECTS INCLUDE: BACKWALLS OF BRIDGES; \mathcal{C} OF ROAD CROSSINGS & OVERHEAD VIADUCTS (GIVE ROAD NAME), OR \mathcal{C} CULVERTS.

- A) IS WIRELINE CROSSING WITHIN DEDICATED STREET? _____ YES; _____ NO;
 B) IF YES, NAME OF STREET _____
 C) TYPE WIRELINE CROSSING: _____ TELEPHONE; _____ TELEVISION; _____ FIBER OPTIC; _____ OTHER; _____
 D) VOLTAGE TO BE CARRIED _____ NO. OF WIRES _____
 E) CURRENT TO BE CARRIED _____
 F) WIRELINE WILL PASS OVER: _____ UNDER: _____ UPRR COMMUNICATION OR SIGNAL LINE?
 WHAT IS THE MINIMUM CLEARANCE BETWEEN WIRES? _____ FEET.
 G) WILL ANY ATTACHMENTS BE MADE TO ANY EXISTING POLES? _____
 H) WILL ANY ATTACHMENTS BE MADE TO RAILROAD'S POLES? _____
 I) WHAT TYPE OF FACILITY WILL LINE BE SERVING? _____
 J) APPLICANT HAS CONTACTED 1-800-336-9193, U. P. COMMUNICATION DEPARTMENT, AND HAS DETERMINED FIBER OPTIC CABLE _____ DOES; _____ DOES NOT; EXIST IN VICINITY OF WORK TO BE PERFORMED. TICKET NO. _____

EXHIBIT "A"

(FOR RAILROAD USE ONLY - DO NOT WRITE IN THIS BOX)

UNION PACIFIC RAILROAD CO.

(SUBDIVISION)

M. P. _____ E. S. _____

OVERHEAD WIRELINE CROSSING

(NEAREST RR STATION) (COUNTY) (STATE)

FOR _____ (APPLICANT)

RR FILE NO. _____ DATE _____

WARNING

IN ALL OCCASIONS, U. P. COMMUNICATIONS DEPARTMENT MUST BE CONTACTED IN ADVANCE OF ANY WORK TO DETERMINE EXISTENCE AND LOCATION OF FIBER OPTIC CABLE.
PHONE : 1-800-336-9193